



CONTROLPOINT DETAILS	Station Number	PSM 5644
Coordinate Information		
Geodetic	Grid	
WGS 84	UTM Zone 43	
Lat: 03°32'44.31110"N	E:	246544.570m
Long: 72°43'10.67270"E	N:	392217.192m
Ellp Height:	Orth Height:	+1.569m
Island Name: Adh.Huruelhi	Date: 16th September 2020	

Monument description & method of survey:

- Established to Type A monument standard. -Stainless steel plate fixed to concrete by Four bolts - Horizontal coordinates fixed by GNSS Static survey.
- 200mm above ground level
- Elevation reduced relative to Local MSL by reference to tide prediction data MET (Hulhule')

General site condition & access:

- Easily accessible area with wide angle of sky visibility
- Located on the south west Conner of the main pool

Owner: Radisun Bule Maldives



SITE INFORMATION

Station Number

P	S	M	5	6	4	4
---	---	---	---	---	---	---

Station Horizon Mask

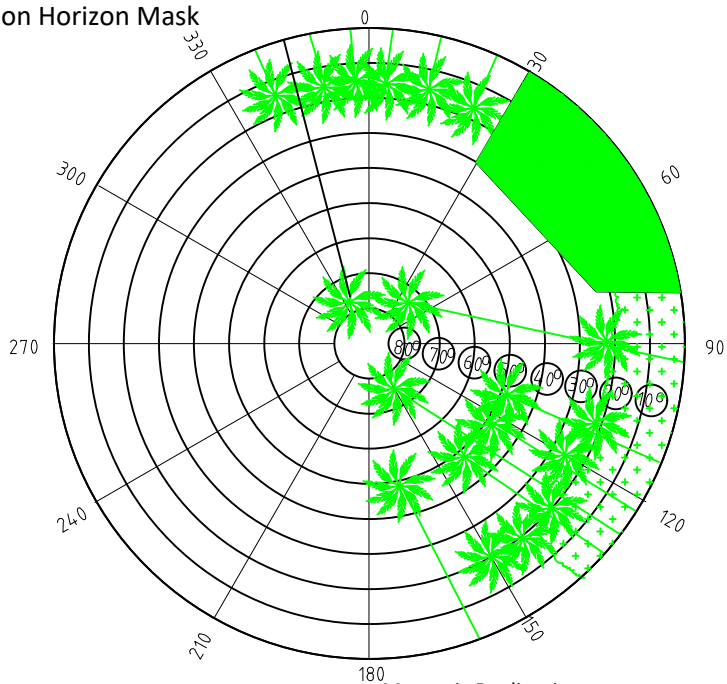

Locality

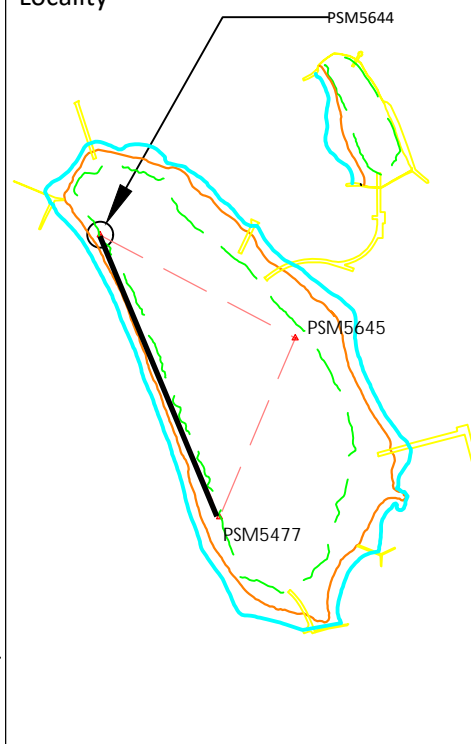

Height above Marker that horizon was mapped from 1.5 m

Magnetic Declination _____
 Declination applied to this figure?
 Yes No

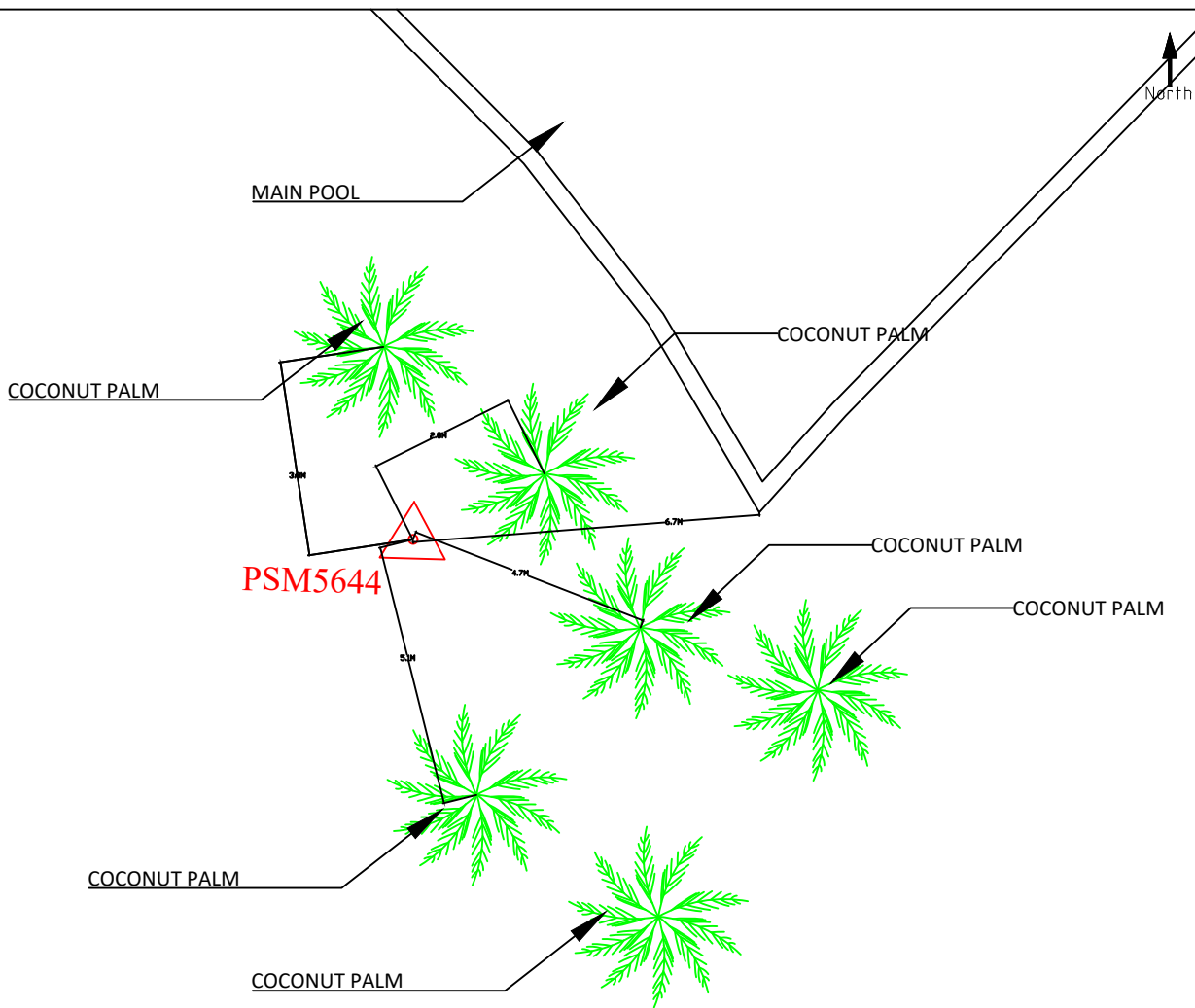

Sketched by: MUBEEN

Scale: Not to Scale

Date: 16 SEP 2020



CONTROLPOINT DETAILS	Station Number	PSM 5477
Coordinate Information		
Geodetic	Grid	
WGS 84	UTM Zone 43	
Lat: 03°32'34.91176"N	E:	246666.991m
Long: 72°43'10.67270"E	N:	391928.063m
Ellp Height:	Orth Height:	+1.339
Island Name: Adh.Huruelhi	Date: 16th September 2020	

Monument description & method of survey:

-Established to Type A monument standard. -Stainless steel plate fixed to concrete by Four bolts - Horizontal coordinates fixed by GNSS Static survey.

-200mm below ground level

-Reduce level of PSM 5644 was transferred to PSM 5477 by using the level difference obtained from the GNSS static survey.

General site condition & access:

- Easily accessible area with wide angle of sky visibility
- Located in front Room 205

Owner: Radisun Bule Maldives



SITE INFORMATION

Station Number

P	S	M	5	4	7	7
---	---	---	---	---	---	---

Station Horizon Mask

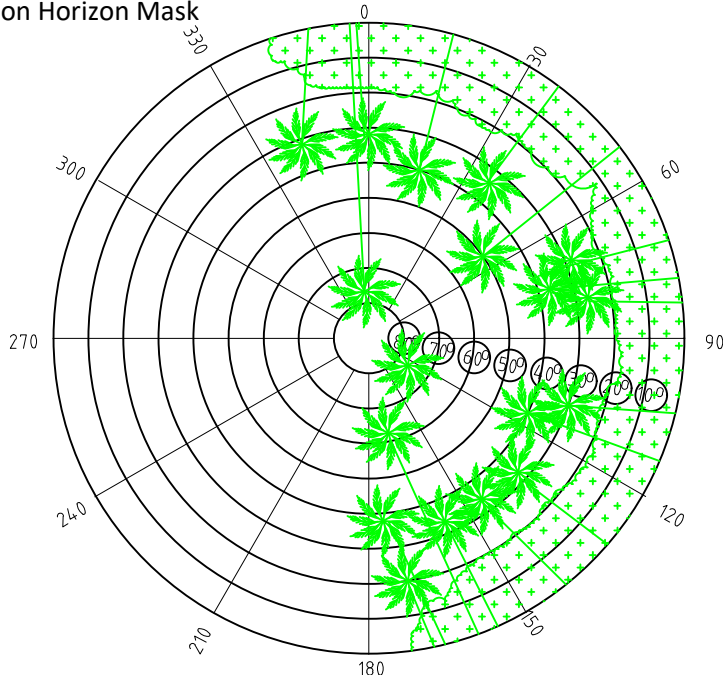

Height above Marker that horizon was mapped from 1.5 m

Magnetic Declination Declination applied to this figure?
 Yes No



Locality

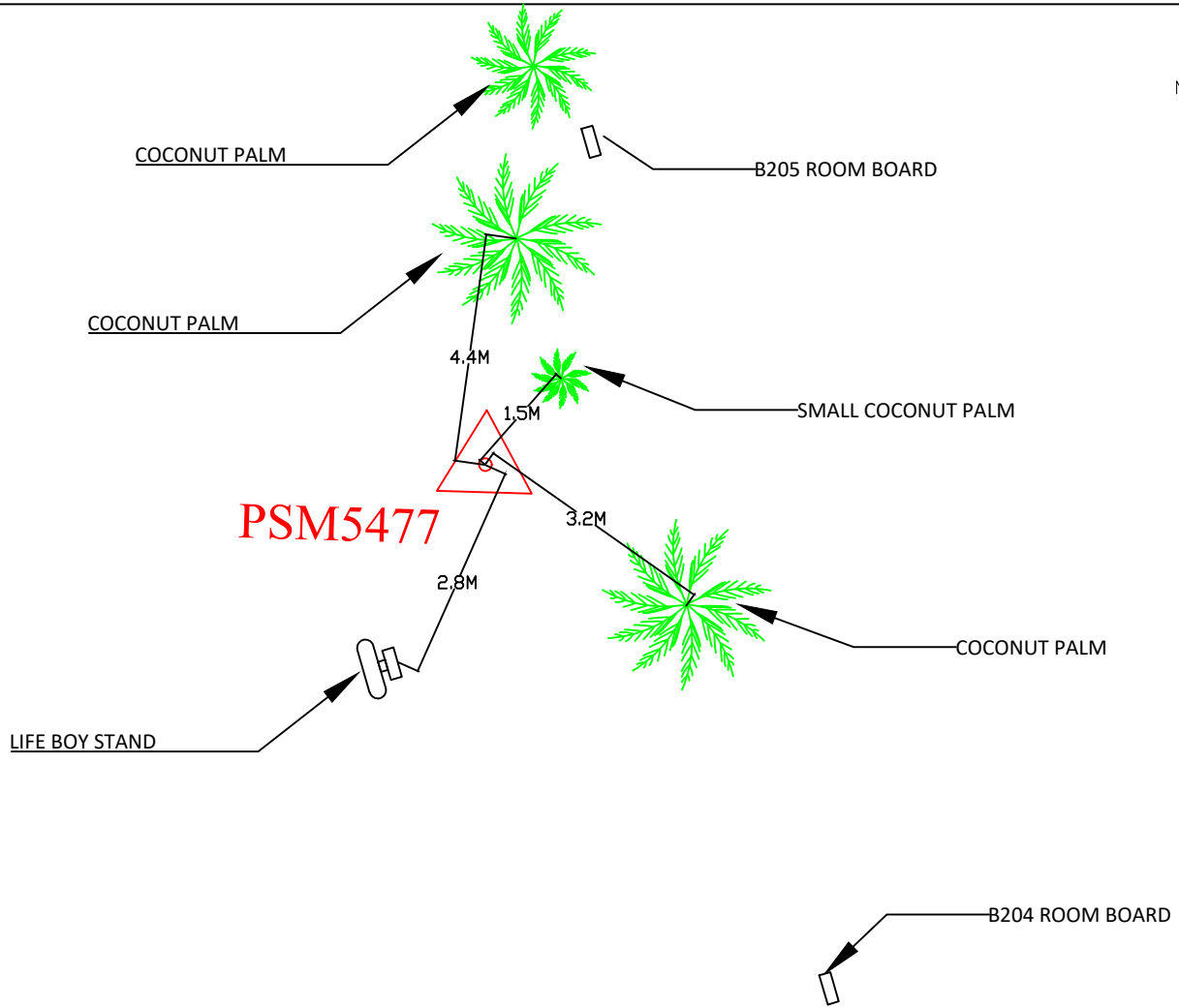
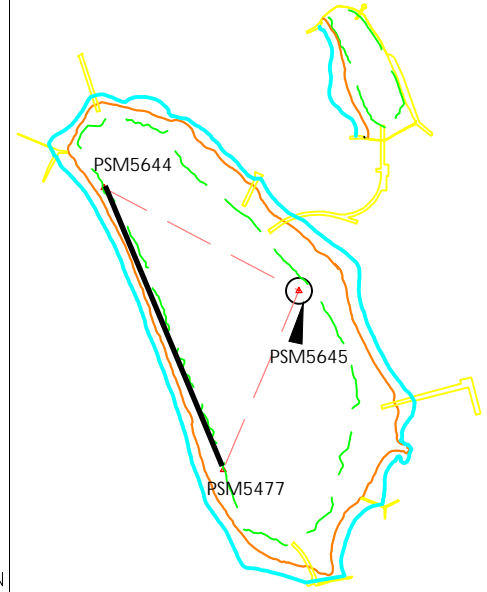

Sketched by: MUBEEN

Scale: Not to Scale

Date: 16 SEP 2020

MALDIVES LAND SURVEY AUTHORITY

MINISTRY OF NATIONAL PLANNING, HOUSING AND INFRASTRUCTURE

Office (PABX): +(960) 3004300, Fax: +(960) 3004254

Email: survey@housing.gov.mv

Web: www.surveyofmaldives.gov.mv,

Ameenee Magu, Maafannu, Male', 20392, Maldives.



CONTROLPOINT DETAILS	Station Number	PSM 5645
Coordinate Information		
Geodetic	Grid	
WGS 84	UTM Zone 43	
Lat: 03°32'40.89363"N	E:	246744.607m
Long: 72°43'13.17190"E	N:	392111.685m
Ellp Height:	Orth Height:	+1.436m
Island Name: Adh.Huruelhi	Date: 16th September 2020	

Monument description & method of survey:

-Established to Type A monument standard. -Stainless steel plate fixed to concrete by Four bolts - Horizontal coordinates fixed by GNSS Static survey.

-200mm above ground level

-Reduce level of PSM 5644 was transferred to PSM 5645 by using the level difference obtained from the GNSS static survey.

General site condition & access:

- Easily accessible area with wide angle of sky visibility
- Located In front of the bar kitchen gate and GM bungalow

Owner: Radisun Bule Maldives



SITE INFORMATION

Station Number

P	S	M	5	6	4	5
---	---	---	---	---	---	---

Station Horizon Mask

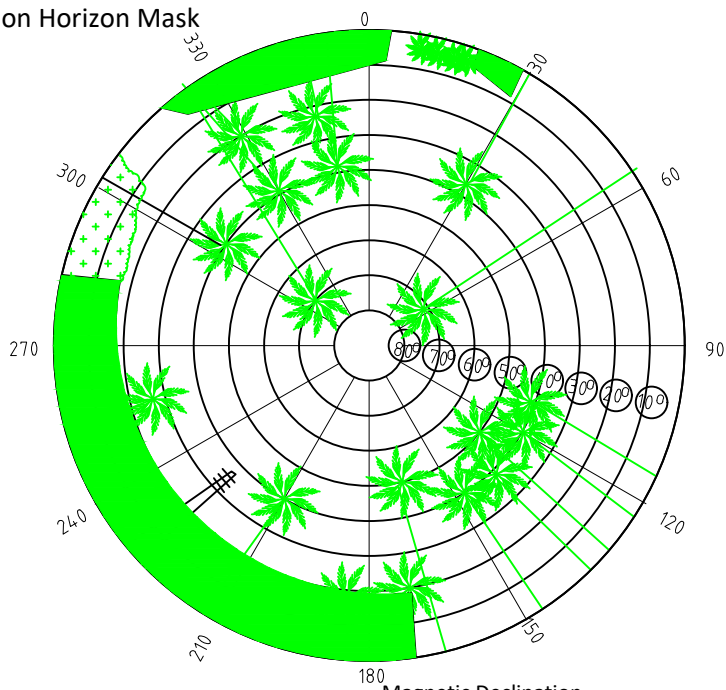

Height above Marker that horizon was mapped from 1.5 m

Magnetic Declination _____
Declination applied to this figure?
 Yes No



Locality

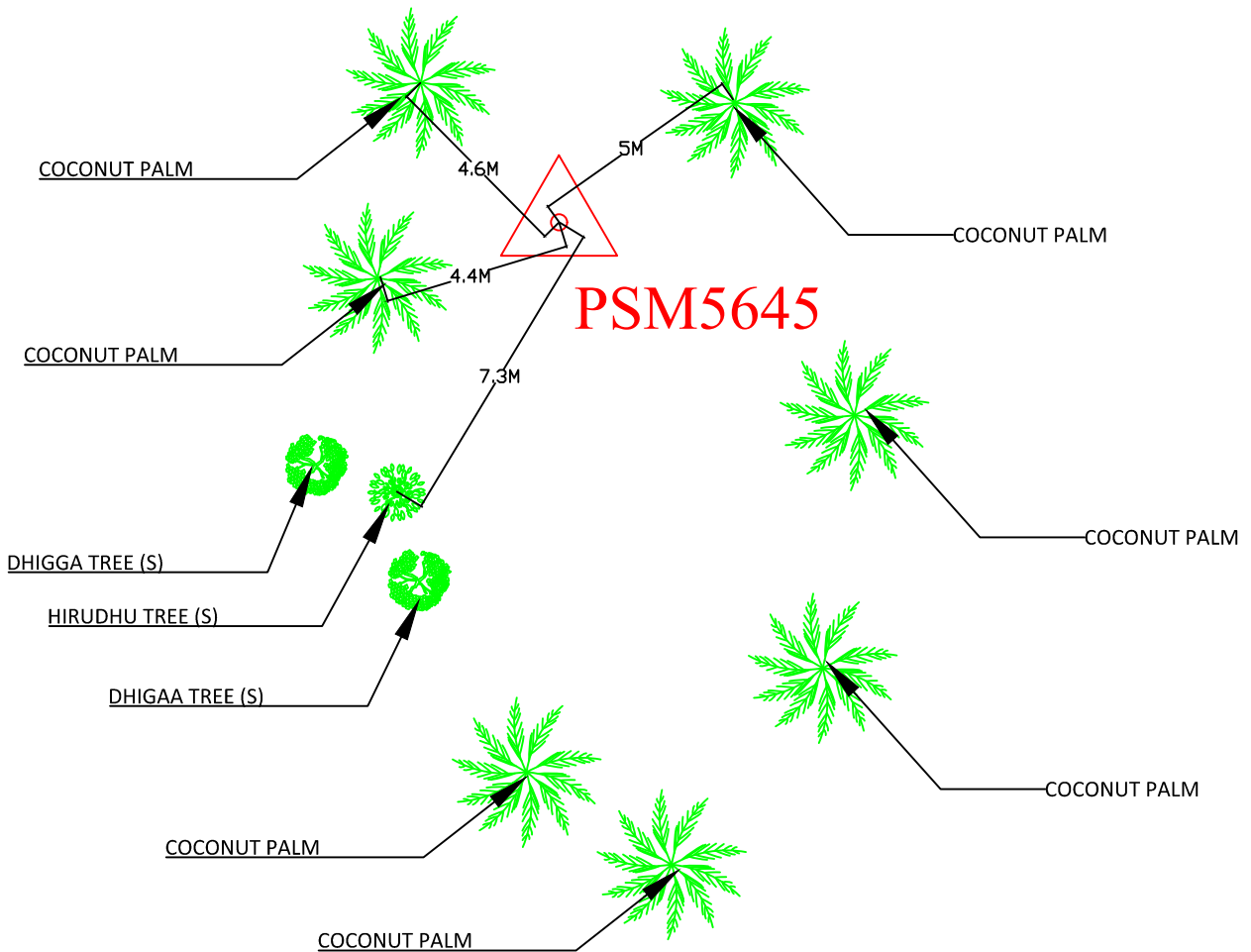
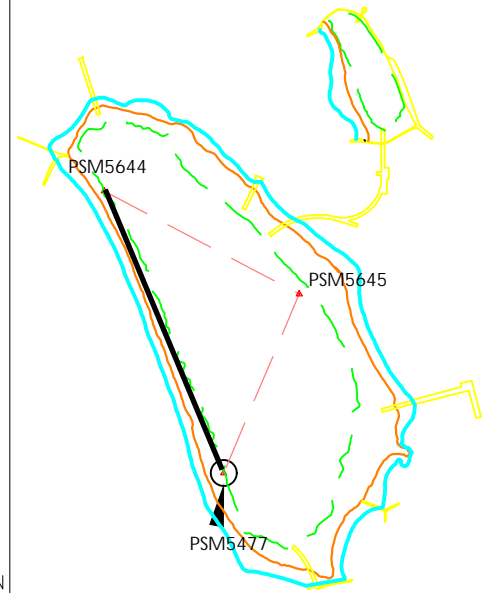

Sketched by: MUBEEN

Scale: Not to Scale

Date: 16 SEP 2020